

# The **TWO STORY** Townhome at Shepherd's Glen

**SHEPHERD'S  
GLEN**



**3 BEDS 2.5 BATHS 2210 SQ. FT.**

Our ranch inspired main floor is perfect for first floor living and entertaining. The large open floorplan boasts a first floor master suite with a **tiled shower** and walk-in closet, living area with cathedral ceilings that open to an optional deck, laundry suite with a **tankless water heater** and a kitchen complete with soft close cabinets, **quartz countertops**, and an adjacent half bathroom.

On the second floor you'll enjoy two large bedrooms with a full bathroom and multi-purpose loft overlooking the living room - excellent for visitors or a home office space.

**Schedule your tour today!**

[www.Shepherds-Glen.com](http://www.Shepherds-Glen.com)

216.702.3956

# The **TWO STORY** Floorplan

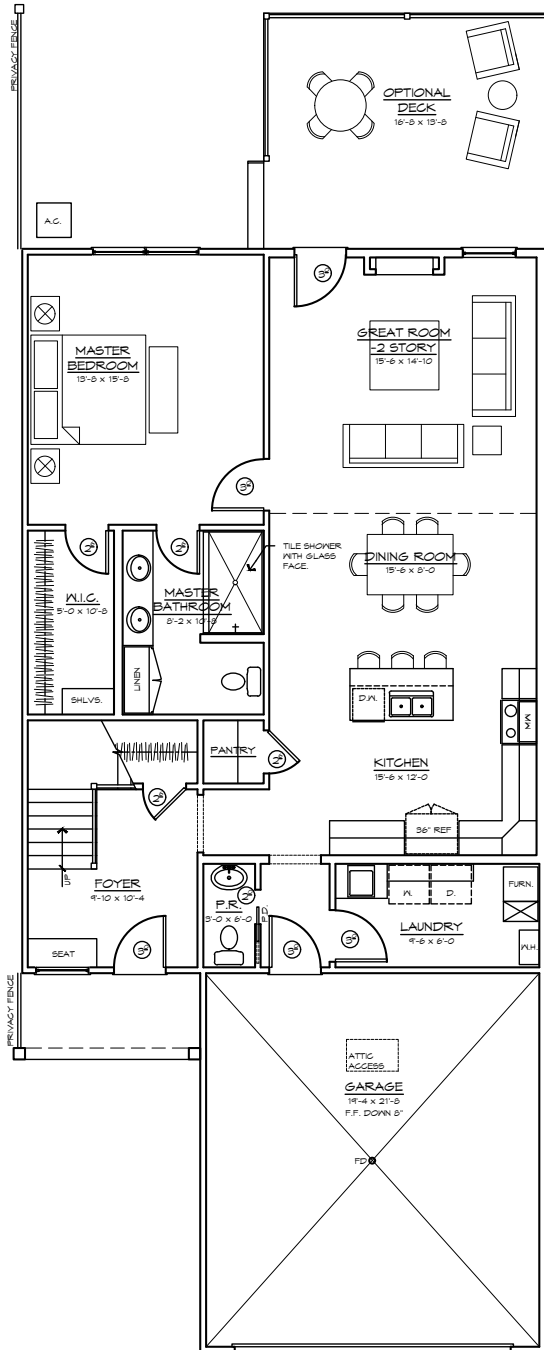

**1ST FLOOR**

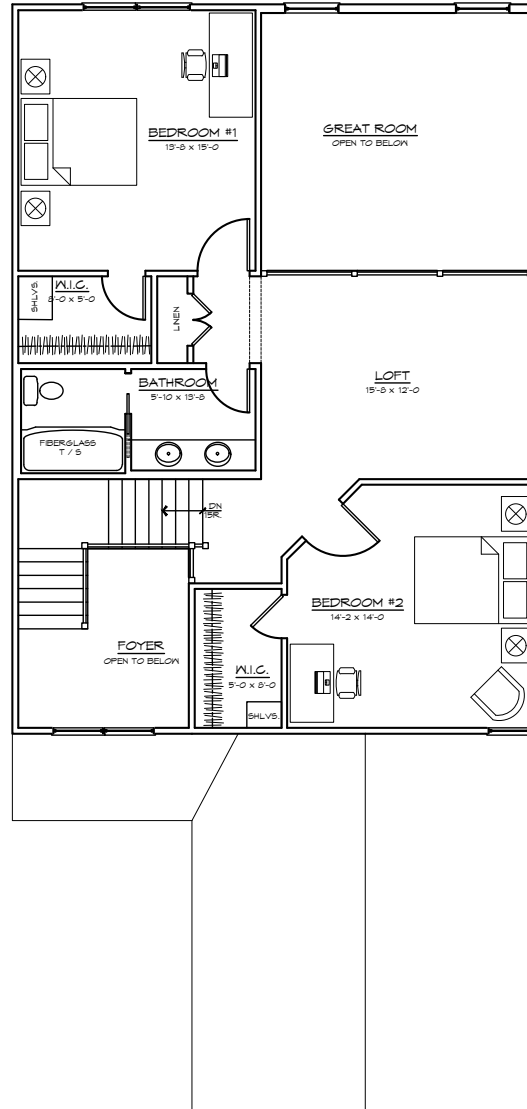

**2ND FLOOR**

Shepherd's Glen - Come Home to Happy  
**Schedule your tour today!**  
[www.Shepherds-Glen.com](http://www.Shepherds-Glen.com) | 216.702.3956

Corporate Office   
 SDK Homes  
 23425 Commerce Park Suite 102  
 Beachwood, Ohio 44122