

The **TWO STORY** Townhome at Shepherd's Glen

**SHEPHERD'S
GLEN**



3 BEDS 2.5 BATHS 2210 SQ. FT.

Our ranch inspired main floor is perfect for first floor living and entertaining. The large open floorplan boasts a first floor master suite with a **tiled shower** and walk-in closet, living area with cathedral ceilings that open to an optional deck, laundry suite with a **tankless water heater** and a kitchen complete with soft close cabinets, **quartz countertops**, and an adjacent half bathroom.

On the second floor you'll enjoy two large bedrooms with a full bathroom and multi-purpose loft overlooking the living room - excellent for visitors or a home office space.

Schedule your tour today!

www.Shepherds-Glen.com

440.578.9995

The **TWO STORY** Floorplan

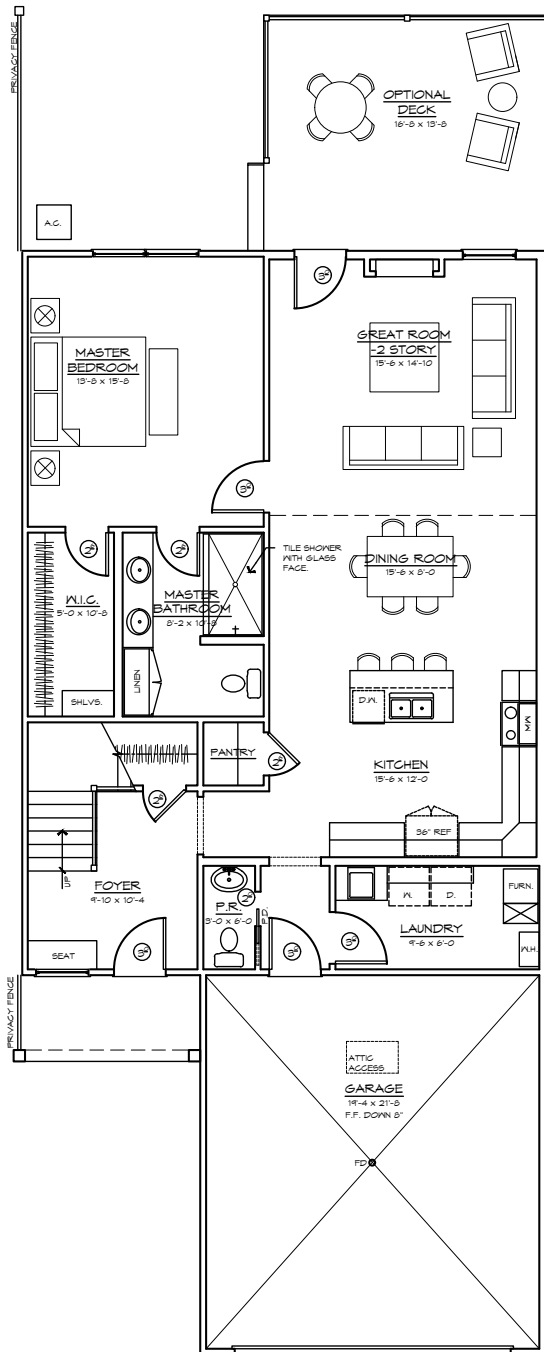

1ST FLOOR

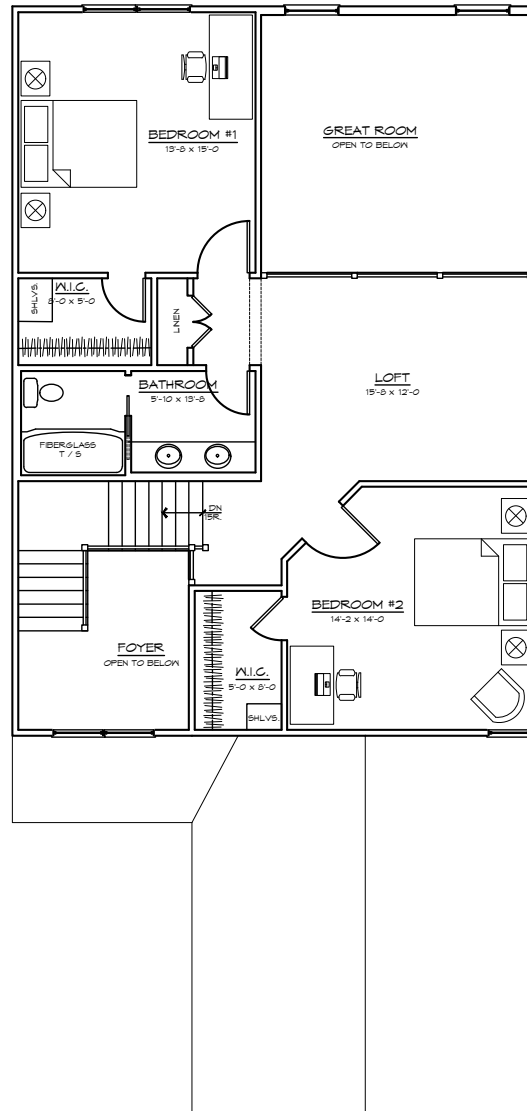

2ND FLOOR

Shepherd's Glen - Come Home to Happy
Schedule your tour today!
www.Shepherds-Glen.com | 440.578.9995

Corporate Office 
 SDK Homes
 23425 Commerce Park Suite 102
 Beachwood, Ohio 44122